

Connection:
tapped hole
M16x1,5 + M20x1,5

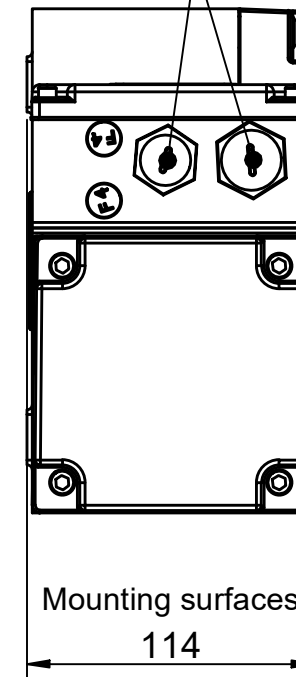

| Configuration | |
|--|-----------------------|
| Description | Property value |
| Type | Compacta AG160 |
| Mains | Three-phase current |
| Mains frequency | 50 Hz |
| Y-Connection | Yes |
| Supply voltage | 230 / 400V AC |
| Supply connection | 3 x 400V AC |
| Output speed rpm | 1,8 min ⁻¹ |
| Output torque in Nm / Duty cycle (ED) in % | 1530 Nm / 60% |
| Self locking | No |
| Ratio | 764 : 1 |
| Lubrication | TRIBOL 800/680 |
| Protection class | IP54 |
| Motor rating | 0,6 kW |
| Current value | 2,65 A |

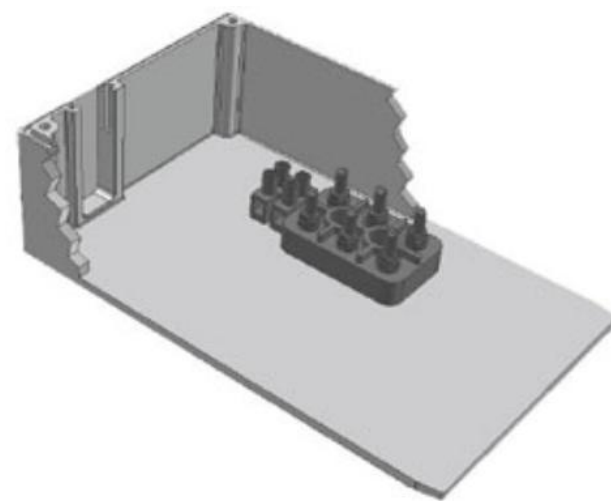

Terminal box (limit switch housing without a switching mechanism).

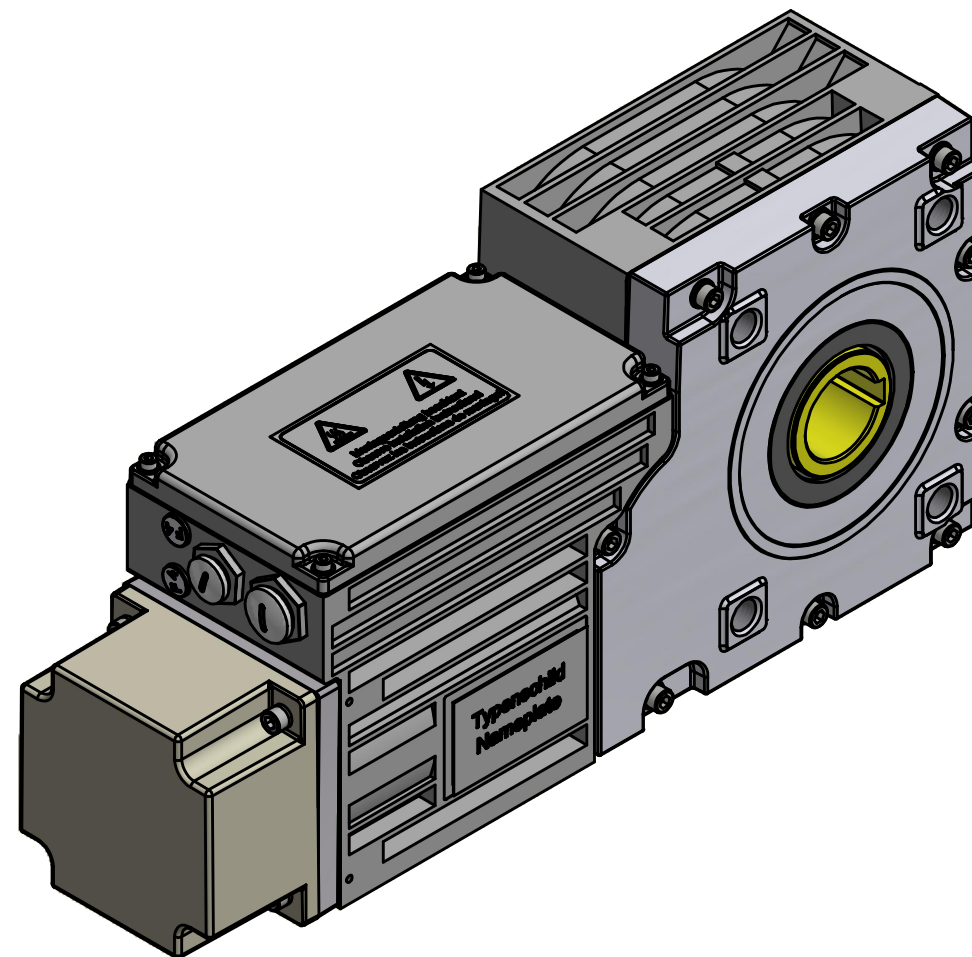

Detail B
Through-going hollow shaft
with keyway

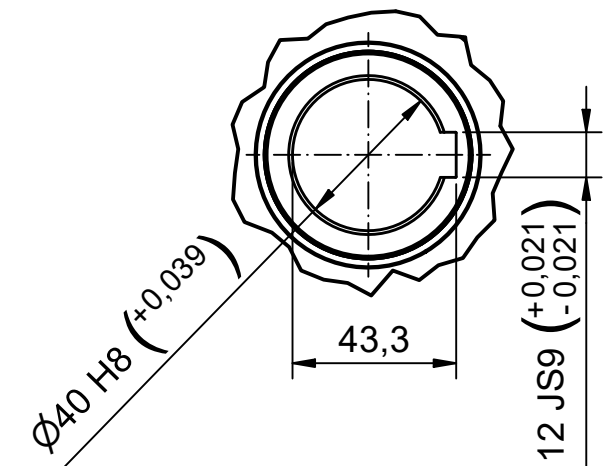

Bezeichnung / designation
Compacta AG160 Induction Motor

Datenblatt / technical datasheet

10000000000162638

Artikel Nr. / article no.
6-160-AG-0006

| | | |
|--------------------|--------------|-------------|
| gezeichnet / drawn | Datum / date | Name / name |
| | 13.10.2023 | mwid |



Framo Morat GmbH & Co. KG
Franz-Morat-Straße 6
D-79871 Eisenbach
www.framo-morat.com