

Connection:
tapped hole
M16x1,5 + M20x1,5

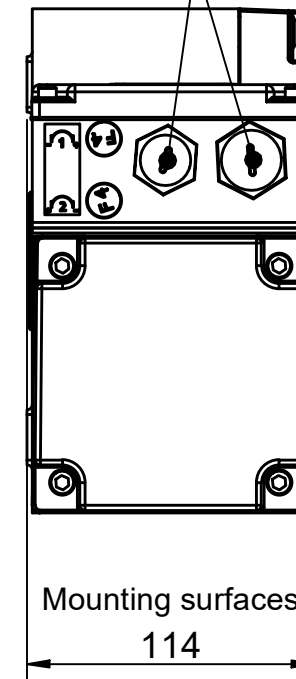

Configuration	
Description	Property value
Type	Compacta AG160
Mains	Three-phase current
Mains frequency	50 Hz
Y-Connection	NO
Supply voltage	230 / 400V AC
Supply connection	3 x 230V AC
Output speed rpm	0,9 min ⁻¹
Output torque in Nm / Duty cycle (ED) in %	1600 Nm / 60%
Self locking	dynamic
Ratio	3111 : 1
Lubrication	TRIBOL 800/680
Limit switch range	1 revolutions on output
Protection class	IP54
Motor rating	1,1 kW
Current value	4,4 A
Equipment	
Spring applied brake 2 Nm / 230 V AC	

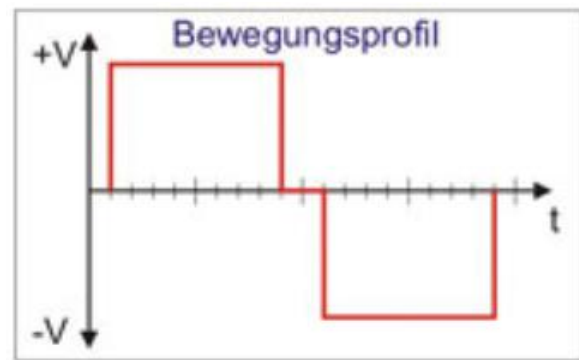
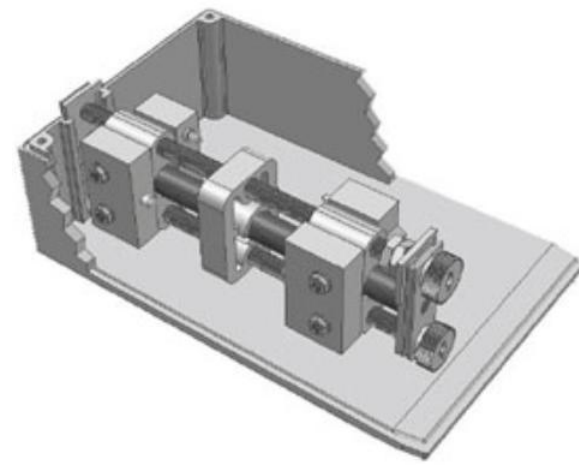

Safeguarded by 2 safety limit switches without reversing contactors for applications with a defined end position in both directions of rotation.

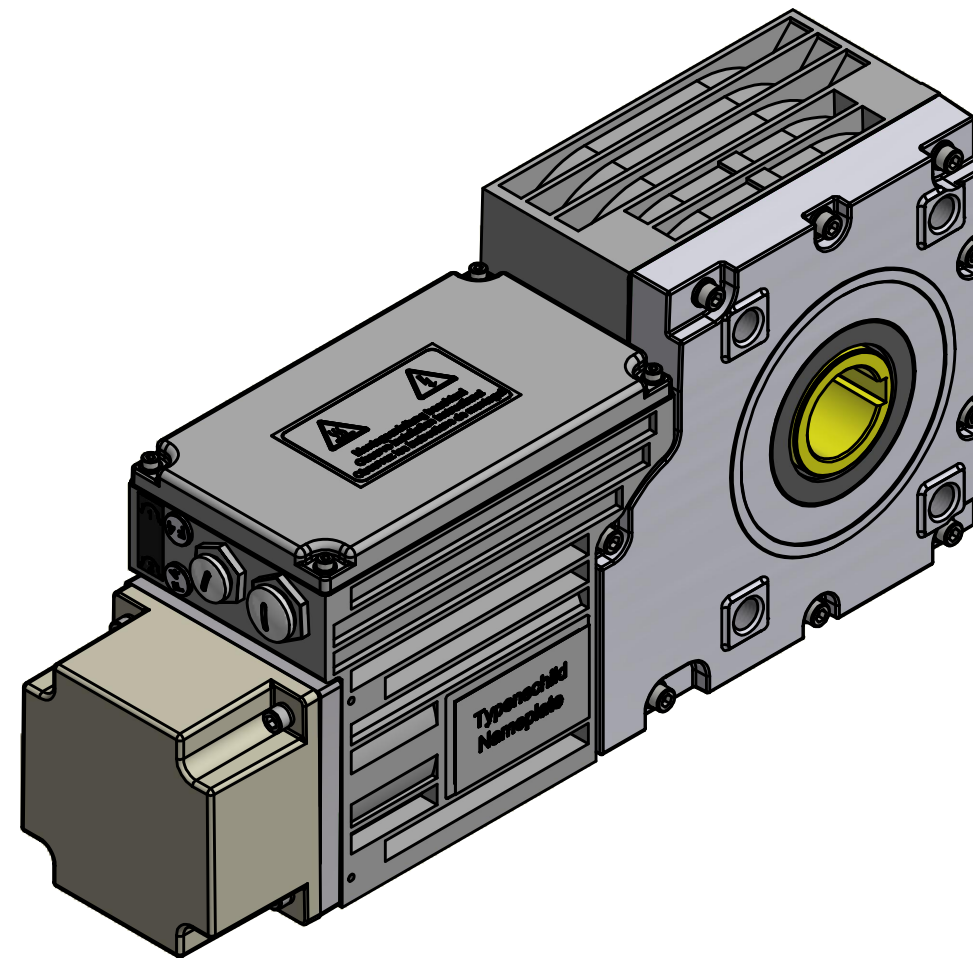

Detail B
Through-going hollow shaft
with keyway

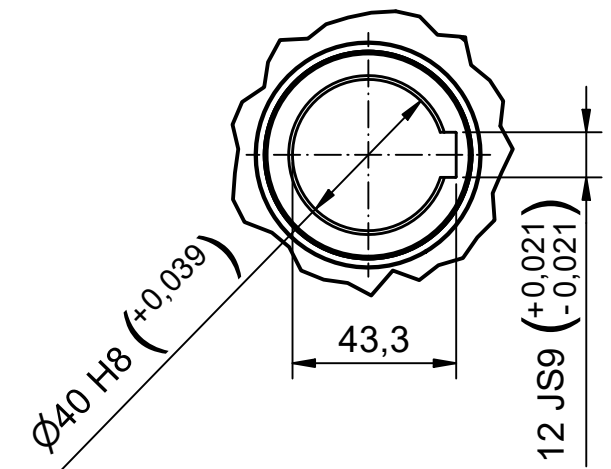

Bezeichnung / designation		
Compacta AG160 Induction Motor		
Datenblatt / technical datasheet		
10000000000162610		 Franz Morat Group
Artikel Nr. / article no. 6-160-AG-0004		
Datum / date	Name / name	Framo Morat GmbH & Co. KG Franz-Morat-Straße 6 D-79871 Eisenbach www.framo-morat.com
gezeichnet / drawn	13.10.2023 mwid	