

Connection:  
tapped hole  
M16x1,5 + M20x1,5

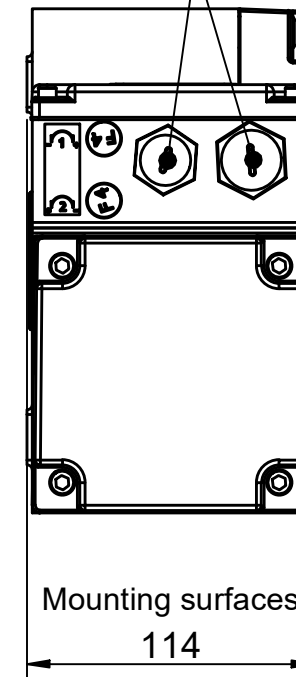

Configuration	
Description	Property value
Type	Compacta AG160
Mains	Three-phase current
Mains frequency	50 Hz
Y-Connection	Yes
Supply voltage	230 / 400V AC
Supply connection	3 x 400V AC
Output speed rpm	5,7 min <sup>-1</sup>
Output torque in Nm / Duty cycle (ED) in %	960 Nm / 60%
Self locking	No
Ratio	490 : 1
Lubrication	TRIBOL 800/680
Limit switch range	0,56 revolutions on output
Protection class	IP54
Motor rating	1,1 kW
Current value	2,5 A
Equipment	
Slide potentiometer 1 kOhm	
Spring applied brake 2 Nm / 24 V DC	

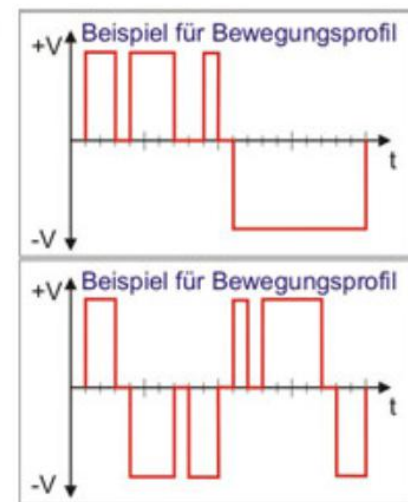
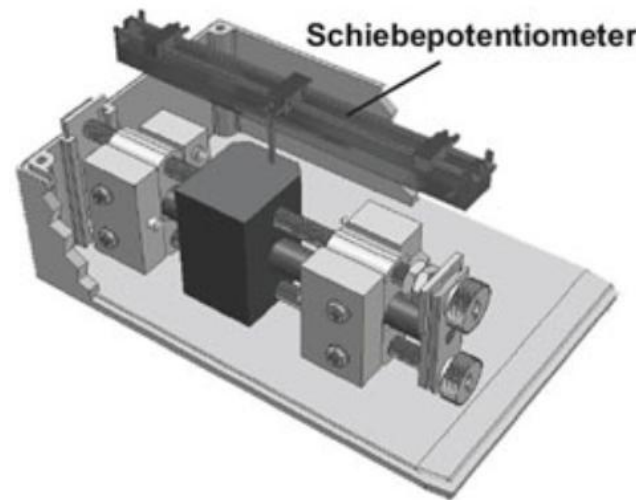

Safeguarded by 2 safety limit switches for applications with a defined end position in both directions of rotation.

Additional position signal using linear potentiometers.

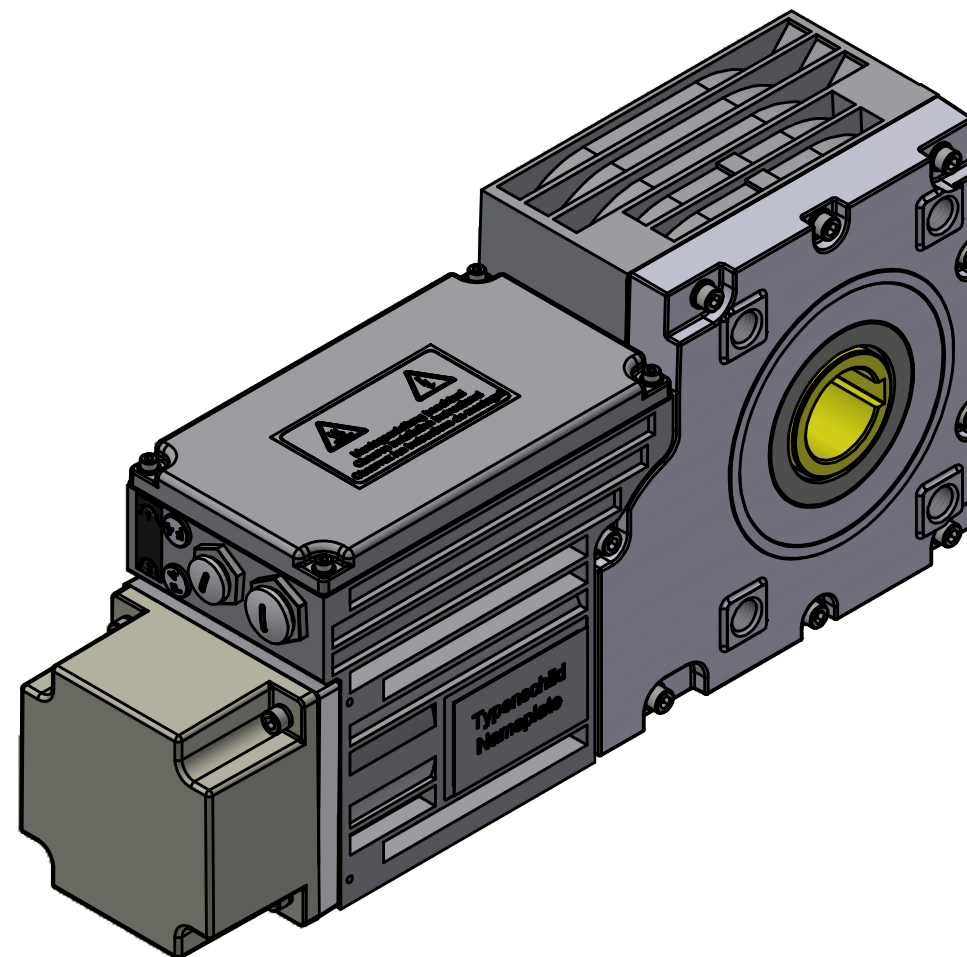

Detail B  
Through-going hollow shaft  
with keyway

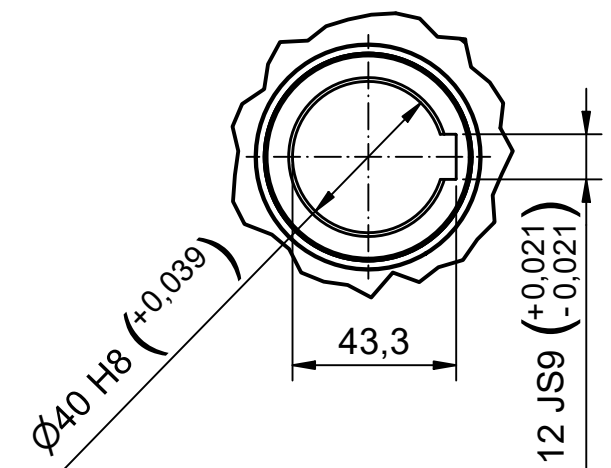

Bezeichnung / designation  
**Compacta AG160 Induction Motor**

Datenblatt / technical datasheet

10000000000162617

Artikel Nr. / article no.  
6-160-AG-0002

gezeichnet / drawn	Datum / date	Name / name
	13.10.2023	mwid



**Framo Morat GmbH & Co. KG**  
Franz-Morat-Straße 6  
D-79871 Eisenbach  
www.framo-morat.com