

6 5 4 3 2 1

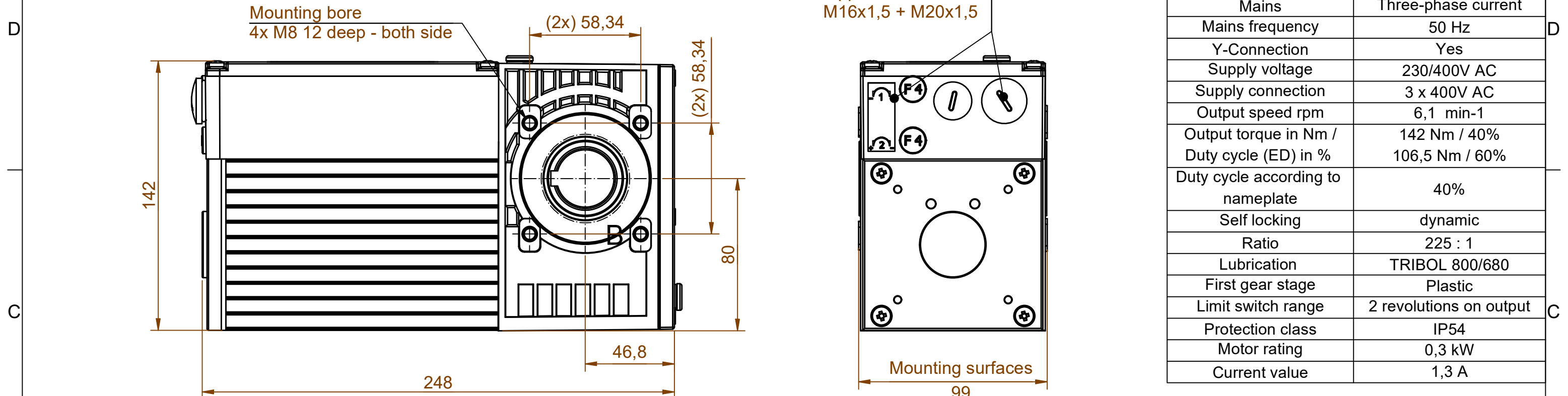

| Configuration                                 |                                |
|---|--------------------------------|
| Description                                   | Property value                 |
| Type  | Compacta MS12                  |
| Mains   | Three-phase current            |
| Mains frequency                               | 50 Hz                          |
| Y-Connection                                  | Yes                            |
| Supply voltage                                | 230/400V AC                    |
| Supply connection                             | 3 x 400V AC                    |
| Output speed rpm                              | 6,1 min-1                      |
| Output torque in Nm /<br>Duty cycle (ED) in % | 142 Nm / 40%<br>106,5 Nm / 60% |
| Duty cycle according to<br>nameplate          | 40%                            |
| Self locking                                  | dynamic                        |
| Ratio   | 225 : 1                        |
| Lubrication                                   | TRIBOL 800/680                 |
| First gear stage                              | Plastic                        |
| Limit switch range                            | 2 revolutions on output        |
| Protection class                              | IP54                           |
| Motor rating                                  | 0,3 kW                         |
| Current value                                 | 1,3 A                          |

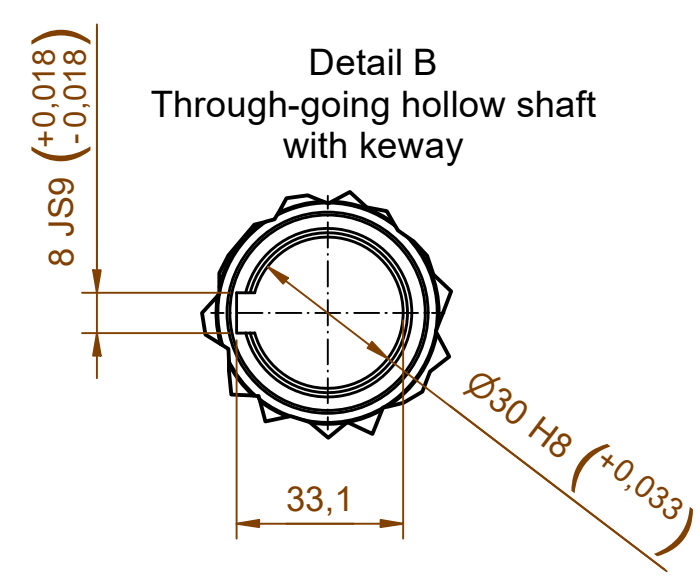
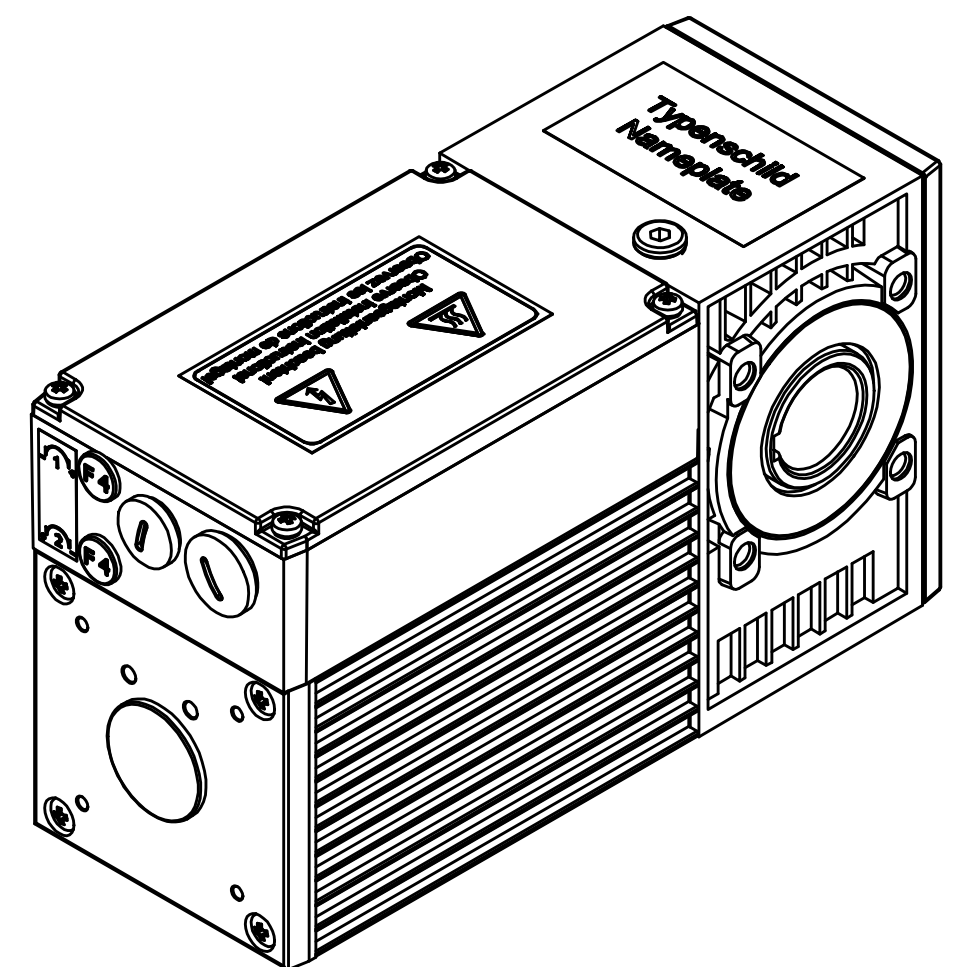
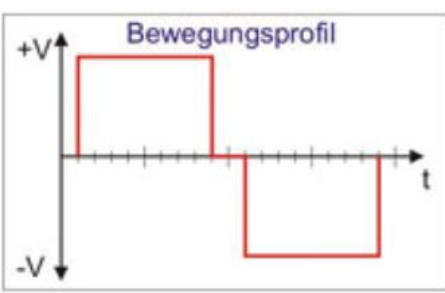
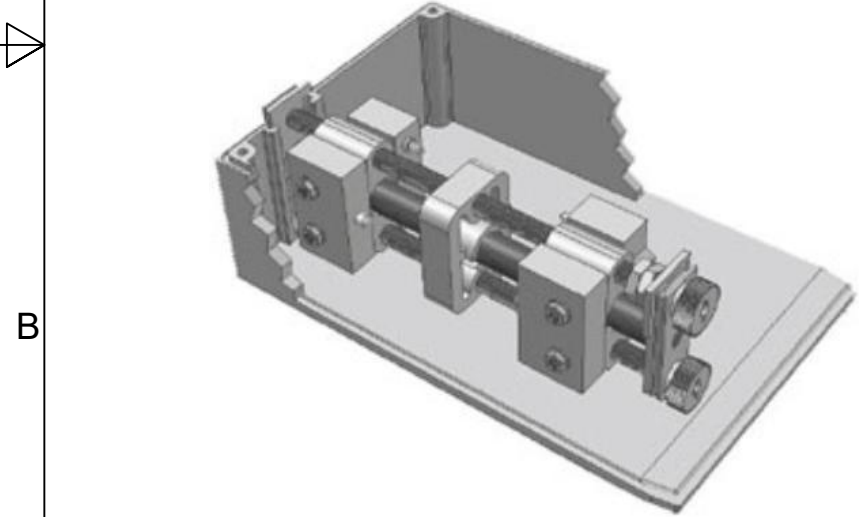

Safeguarded by 2 safety limit switches without reversing contactors for applications with a defined end position in both directions of rotation

|   |              |             |
|---|--------------|-------------|
| Bezeichnung / designation   |              |             |
| Compacta MS12 Induction Motor   |              |             |
| Datenblatt / technical datasheet  |              |             |
| 10000000000176193   |              |             |
| Artikel Nr. / article no.<br>6-12-MS-0037   |              |             |
|   | Datum / date | Name / name |
| gezeichnet / drawn  | 14.10.2024   | mwid        |
| <br>Franz Morat Group<br><b>Framo Morat GmbH &amp; Co. KG</b><br>Franz-Morat-Straße 6<br>D-79871 Eisenbach<br>www.framo-morat.com |              |             |

6 5 4 3 2 1