

Configuration	
Description	Property value
Type	Compacta MS12
Mains	Three-phase current
Mains frequency	50 Hz
Y-Connection	Yes
Supply voltage	230/400V AC
Supply connection	3 x 400V AC
Output speed rpm	6,1 min ⁻¹
Output torque in Nm / Duty cycle (ED) in %	142 Nm / 40% 106,5 Nm / 60% 106,5 Nm / 100%
Duty cycle according to nameplate	100%
Self locking	dynamic
Ratio	225 : 1
Lubrication	TRIBOL 800/680
First gear stage	Plastic
Protection class	IP54
Motor rating	0,23 kW
Current value	1,0 A
Equipment	
Forced cooling fan	
Vent valve with sealing ring	

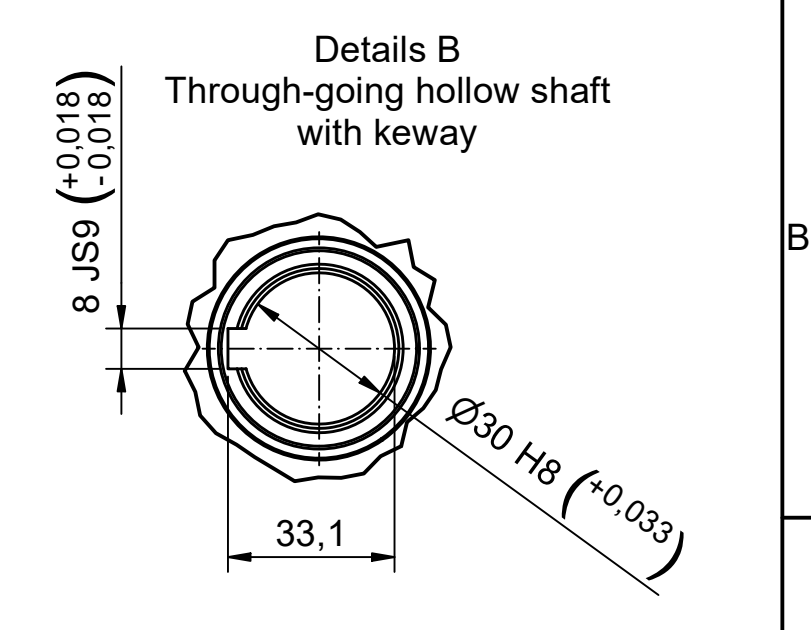
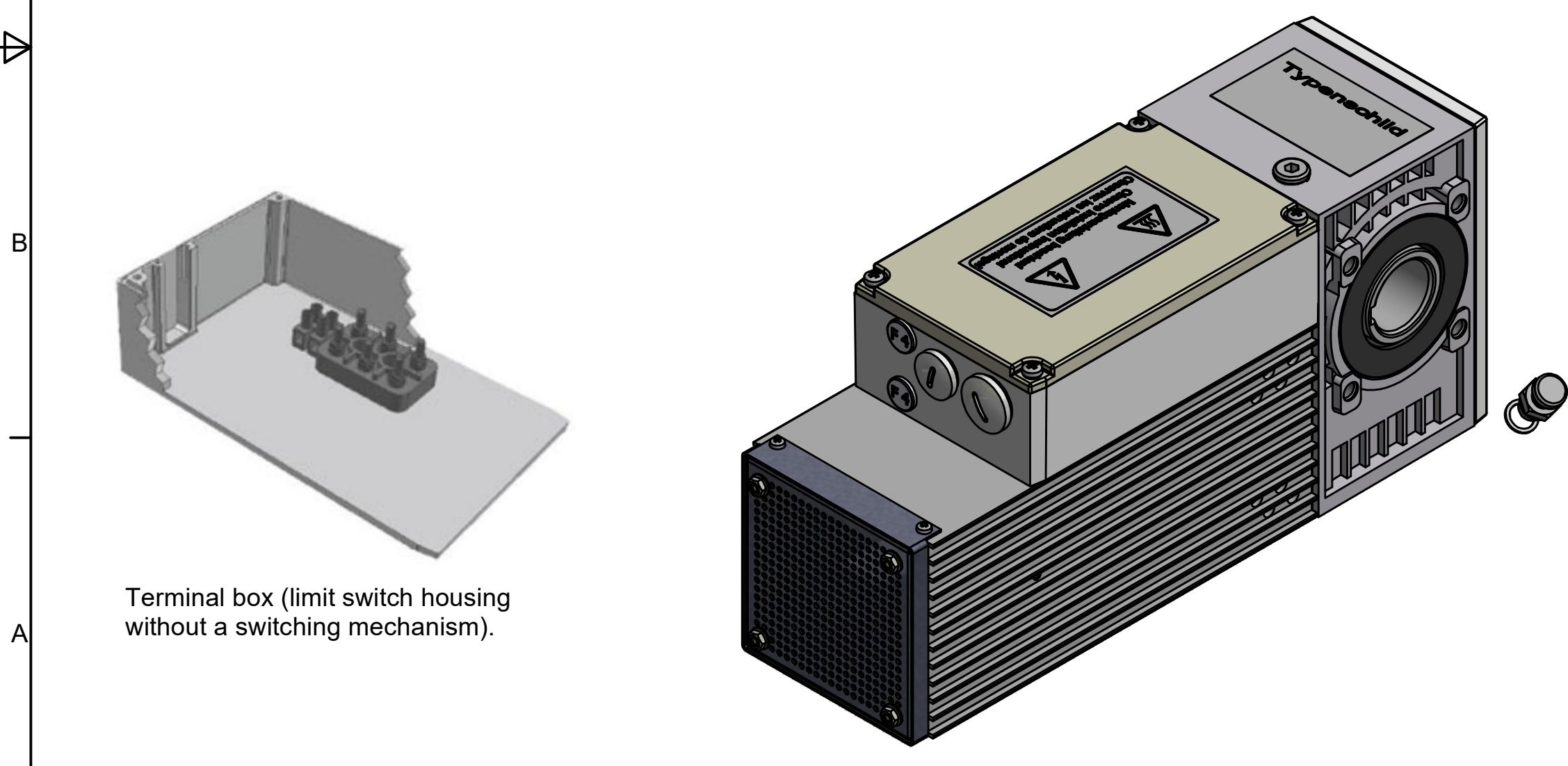

Bezeichnung / designation		
Compacta MS12 Induction Motor		
Datenblatt / technical datasheet		
10000000000168823		 Franz Morat Group
Artikel Nr. / article no. 6-12-MS-0036		
gezeichnet / drawn	Datum / date 04.03.2024	Name / name mwid
Framo Morat GmbH & Co. KG Franz-Morat-Straße 6 D-79871 Eisenbach www.framo-morat.com		