

Configuration	
Description	Property value
Type	Compacta MS12
Mains	Three-phase current
Mains frequency	50 Hz
Y-Connection	Yes
Supply voltage	230 / 400V AC
Supply connection	3 x 400V AC
Output speed rpm	6,1 min-1
Output torque in Nm / Duty cycle (ED) in %	142 Nm / 40% 106,5 Nm / 60%
Duty cycle according to nameplate	40%
Self locking	dynamic
Ratio	225 : 1
Lubrication	TRIBOL 800/680
First gear stage	Plastic
Limit switch range	15 revolutions on output
Protection class	IP54
Motor rating	0,3 kW
Current value	1,0 A
Equipment	
Spring applied brake 2Nm / 24V DC	
Slide potentiometer 1 kOhm	

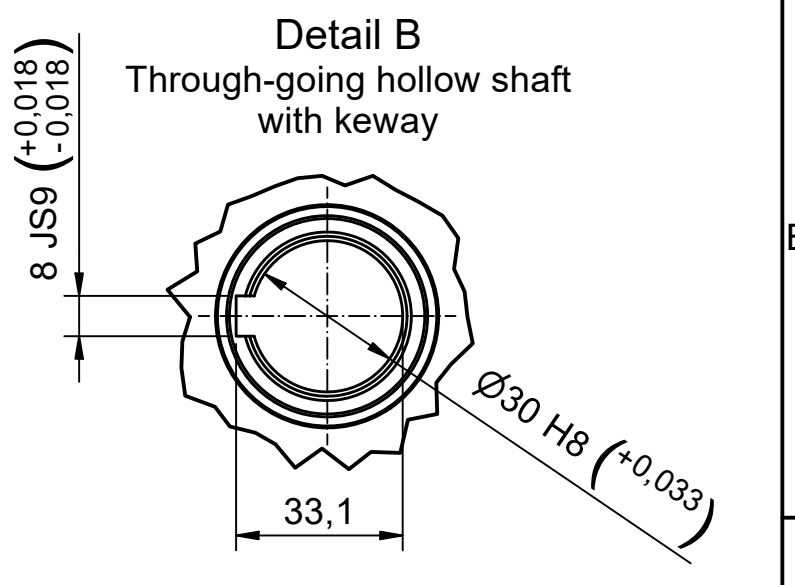
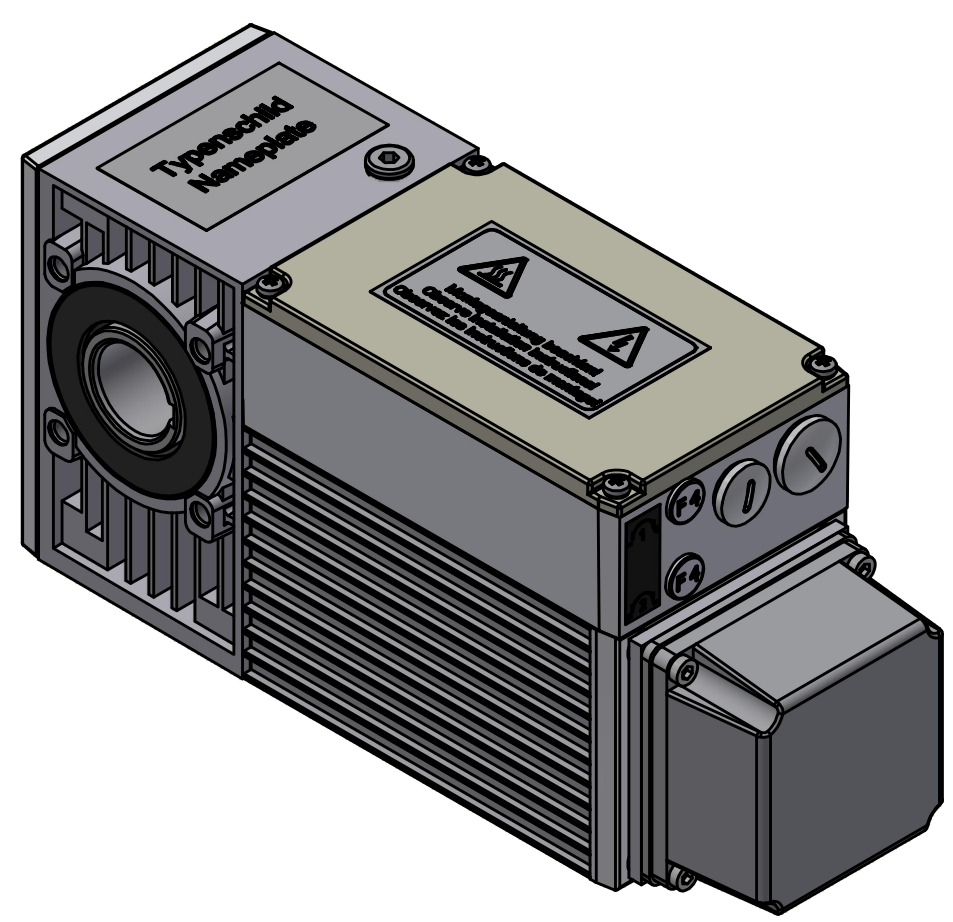
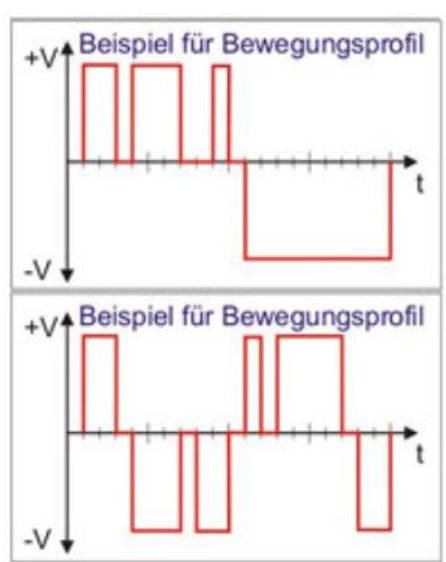
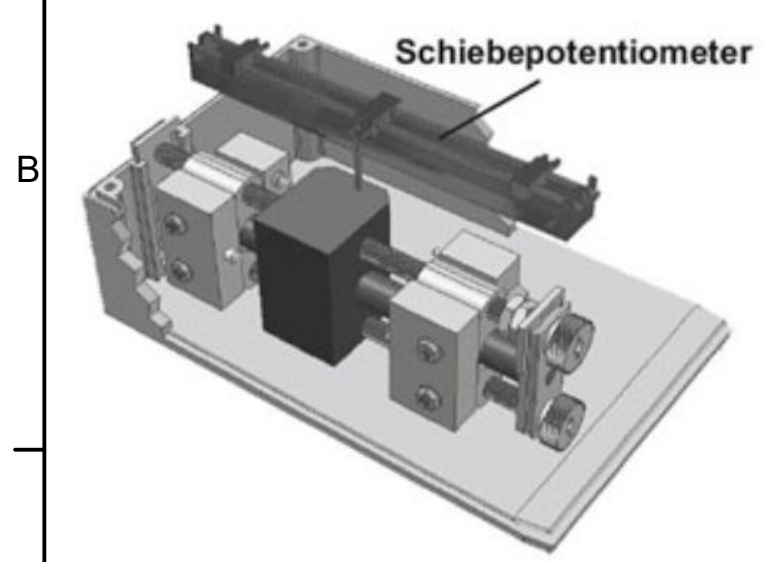

Safeguarded by 2 safety limit switches for applications with a defined end position in both directions of rotation.

Additional position signal using linear potentiometers.

Bezeichnung / designation			Compacta MS12 Induction Motor		
Datenblatt / technical datasheet					
10000000000162281			 Franz Morat Group		
Artikel Nr. / article no. 6-12-MS-0014					
Datum / date		Name / name	<b>Framo Morat GmbH &amp; Co. KG</b> Franz-Morat-Straße 6 D-79871 Eisenbach www.framo-morat.com		
gezeichnet / drawn		mwid			
19.09.2023					