

Connection:  
tapped hole  
M16x1,5 + M20x1,5

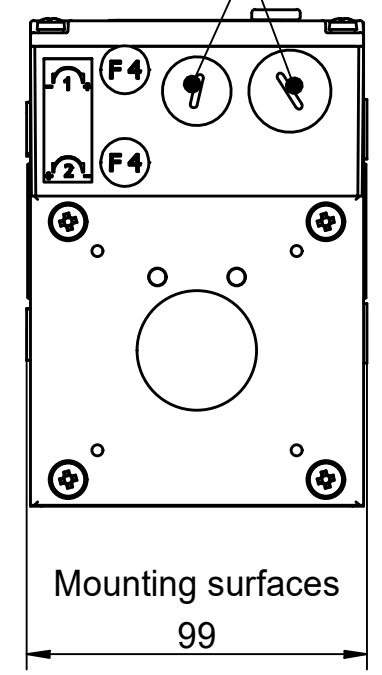

Configuration	
Description	Property value
Type	Compacta MS12
Mains	Three-phase current
Mains frequency	50 Hz
Y-Connection	Yes
Supply voltage	230 / 400V AC
Supply connection	3 x 400V AC
Output speed rpm	47,6 min <sup>-1</sup>
Output torque in Nm / Duty cycle (ED) in %	45,5 Nm / 40% 34 Nm / 60%
Duty cycle according to nameplate	40%
Self locking	No
Ratio	29 : 1
Lubrication	TRIBOL 800/680
First gear stage	Plastic
Limit switch range	15 revolutions on output
Protection class	IP54
Motor rating	0,3 kW
Current value	1,0 A
Equipment	
Anchor cone brake	
Slide potentiometer 1 kOhm	

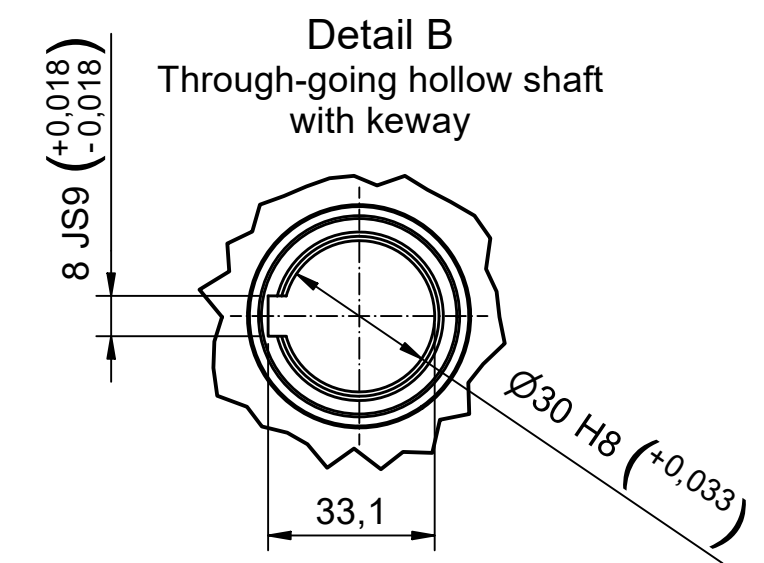
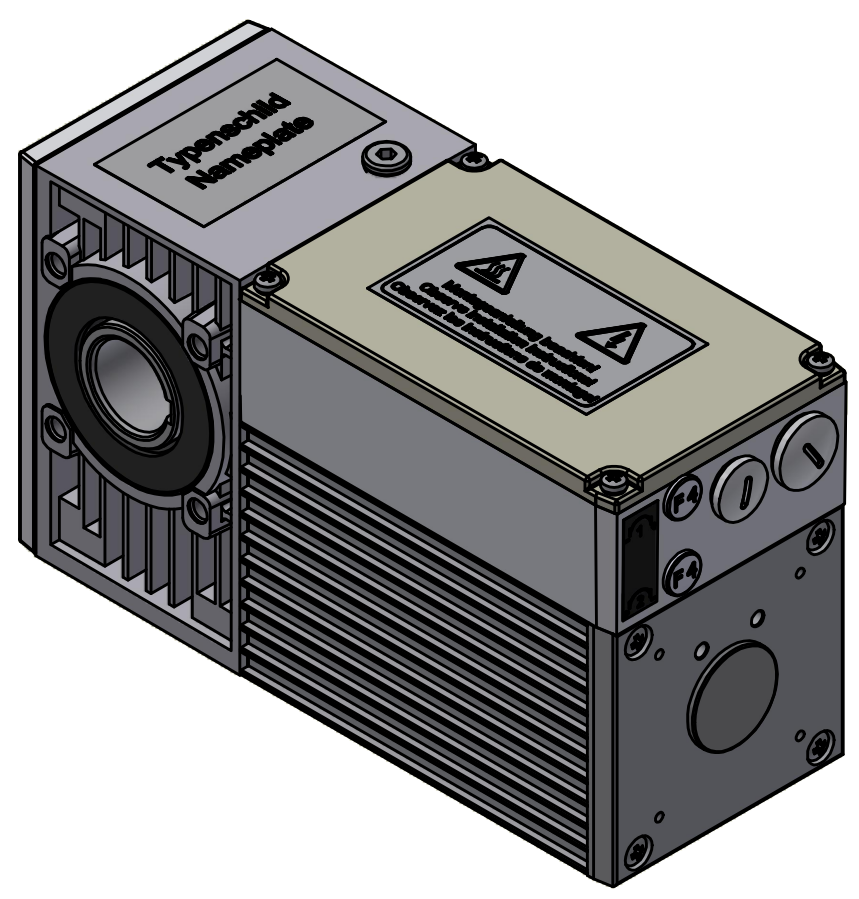
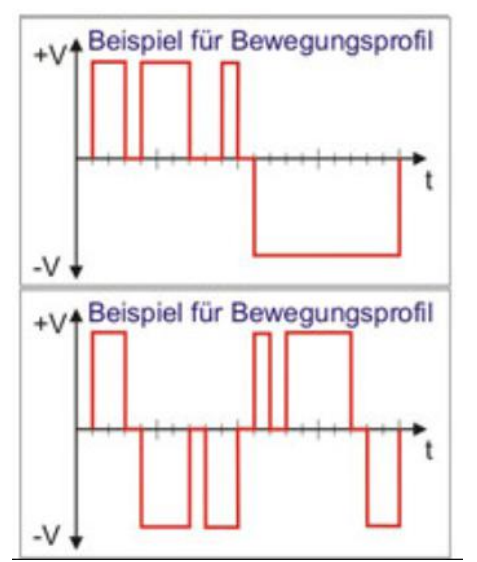
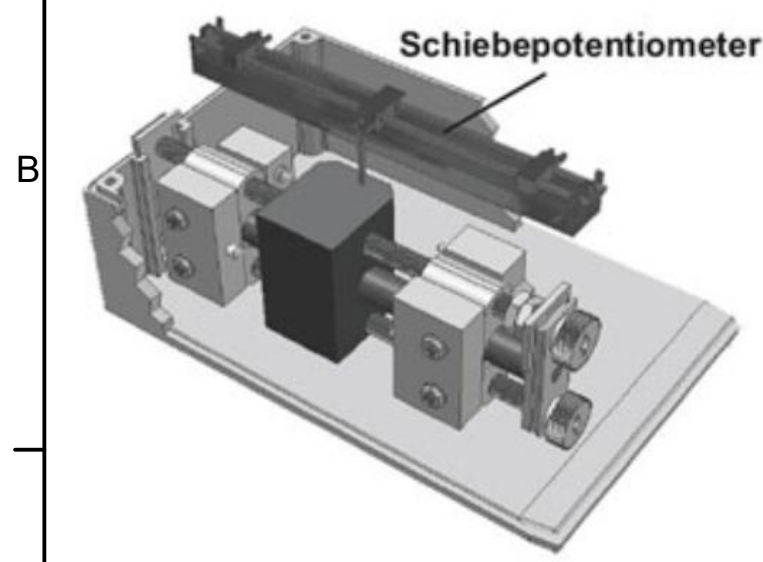

Safeguarded by 2 safety limit switches  
for applications with a defined end position  
in both directions of rotation.

Additional position signal using  
linear potentiometers.

Bezeichnung / designation <b>Compacta MS12 Induction Motor</b>		
Datenblatt / technical datasheet		
10000000000162269		
Artikel Nr. / article no. 6-12-MS-0013		
gezeichnet / drawn	Datum / date 19.09.2023	Name / name mwid
<b>Framo Morat GmbH &amp; Co. KG</b> Franz-Morat-Straße 6 D-79871 Eisenbach www.framo-morat.com		